

# BLINDS *please.*

## Vertical Blinds OUTSIDE MOUNT

**For installation, you will need the following tools:**

1. Pencil
2. Phillips screwdriver
3. Steel tape measure
4. Drill with 1/16" bit (recommended)

**Your Vertical blinds come with the following components:**

- |  |                                |
|--|--------------------------------|
| Headrail                                     | Louvers (fabric or vinyl)      |
| Mounting Clips                               | Wall Bracket (wall mount only) |
| Nuts (wall mount only)                       | Bolts (wall mount only)        |
| Mounting Screws                              | Valance (optional)             |
| Valance Corners (optional)                   | Valance Ends (optional)        |
| Valance Clips (with wall mount valance only) |                                |
| Tension Pulley                               |                                |

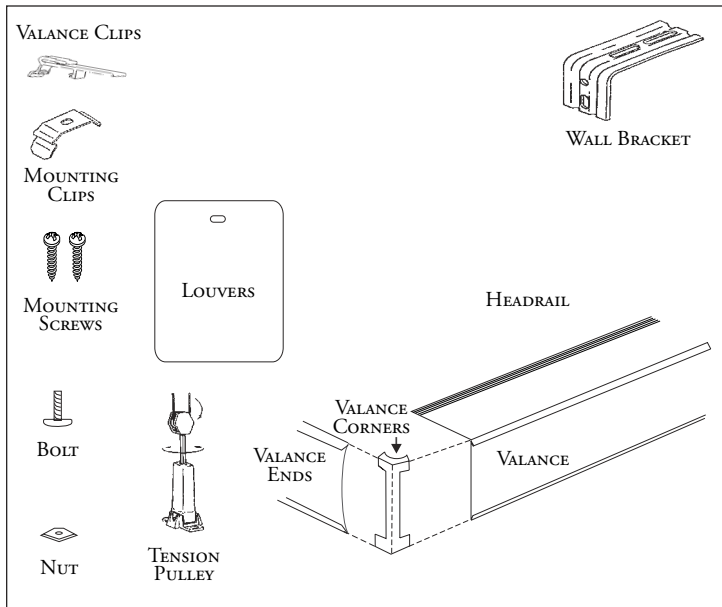

### HEADRAIL INSTALLATION

- 1** Wall bracket should be mounted so that the top of the bracket is 1/2" taller than the total height of the blinds; this allows for clearance at the bottom (if floor length). A) Position mounting bracket so that it is 2" above the window/door to allow for height of the bracket and at least 3" in from the end of the headrail. B) Mark the screw hole locations. C) Space the remaining brackets evenly. D) Drill at each mark. Turn the clip on mounting bracket sideways to allow easy access to the top screw hole in bracket. Fasten mounting brackets to wall with screws. Note: A screw in plain drywall or plaster will NOT provide a lasting installation. After brackets are securely mounted to the wall, position the mounting clip so the front of clip is flush with the front of the mounting bracket.

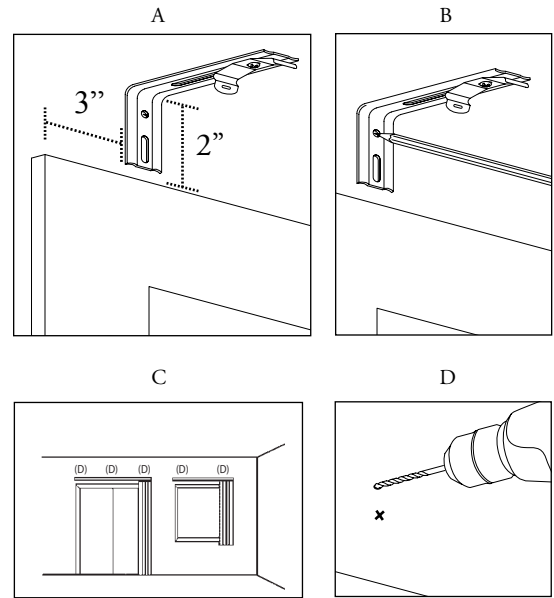

- 2** Snap headrail in place by inserting edge of headrail into front edge of mounting clip and rotating back until headrail snaps firmly in place.

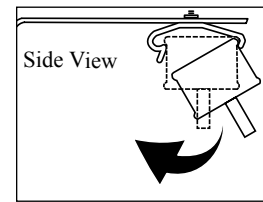

### LOUVER INSTALLATION

- 1** Rotate louver stems so that vanes will be installed in the open position. See operating instructions if all clips are not facing the same direction.

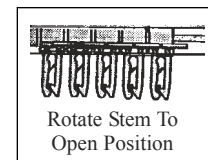

- 2** Insert the slotted end of the louvers into the stem as far as it will go. Then gently pull down, approximately 1/4" to ensure that it catches on the hook inside the louver stem. Make sure all louvers are facing the same direction. Louvers can be removed by inserting a credit card or similar between the louver and the stem leg that has the hook on it.

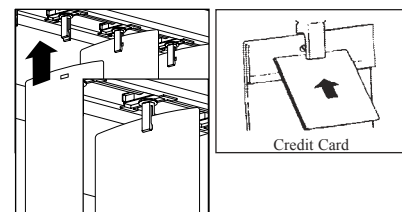

- 3 Fabric Louvers Only** Insert weights, unless already assembled, into the pockets at the bottom of the louver.

## CORD TENSION PULLEY INSTALLATION

- 1** The cord tension pulley should be mounted slightly toward the back as to allow for free rotation of the vanes. A light amount of tension should be used - too much tension will interfere with smooth operation of blinds.

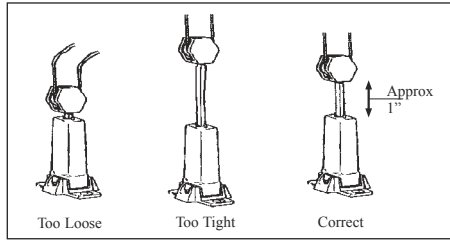

- 2** Hold the pulley base in the desired location and mark the screw holes. Drill at marks, then mount the tension pulley with provided screws.

## OPTIONAL: VALANCE INSTALLATION

- 1** Snap valance clips onto the top of the headrail by placing front groove of clip over the front lip of the headrail. Then press firmly on rear of the clip until it snaps into place. Clips should be 4" from each end of the headrail, with remaining clips spaced evenly.

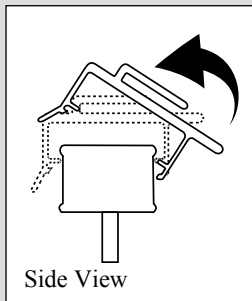

- 2** Insert valance dust cover into the top clip of the valance clips. Align valance to be centered with the headrail. Insert so that the back of the valance is approximately 1/2" away from the louvers when in opened position.

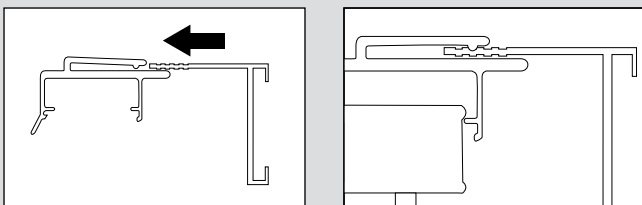

## OPTIONAL: VALANCE RETURNS

- 3** Measure distance from front face of valance to the wall. Mark valance return at the measured size. Cut return at mark with scissors. Insert valance return and corner joint to the valance in the same fashion. Repeat for other end of valance.

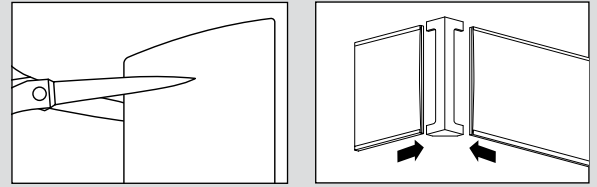

## OPERATING YOUR VERTICAL BLINDS

### **To Open Louvers:**

Pull cord to rotate the louvers to the desired position.

### **To Open Blind:**

Traverse the louvers across the headrail using the cord. Stacking of the louvers will vary depending on the draw (right, left or split) ordered.

### **To Realign Louvers out of Sync**

Pull cord until louvers are all closed. Continue pulling until you hear clicking sounds. Pull cord again rotating the vanes to close them in the other direction and pull once more until you hear clicking sounds.

## PROPER CARE OF VERTICAL BLINDS

Clean vinyl louvers with a soft damp cloth. Fabric louvers can be vacuumed with a soft attachment or spot cleaned with a mild detergent/damp cloth.

# BLINDS *please.*

## Vertical Blinds INSIDE MOUNT

For installation, you will need the following tools:

1. Pencil
2. Phillips screwdriver
3. Steel tape measure
4. Drill with 1/16" bit (recommended)

Your Vertical blinds come with the following components:

Headrail	Louvers (fabric or vinyl)
Mounting Clips	Mounting Screws
Valance (optional)	Valance Corners (optional)
Valance Ends (optional)	Tension Pulley

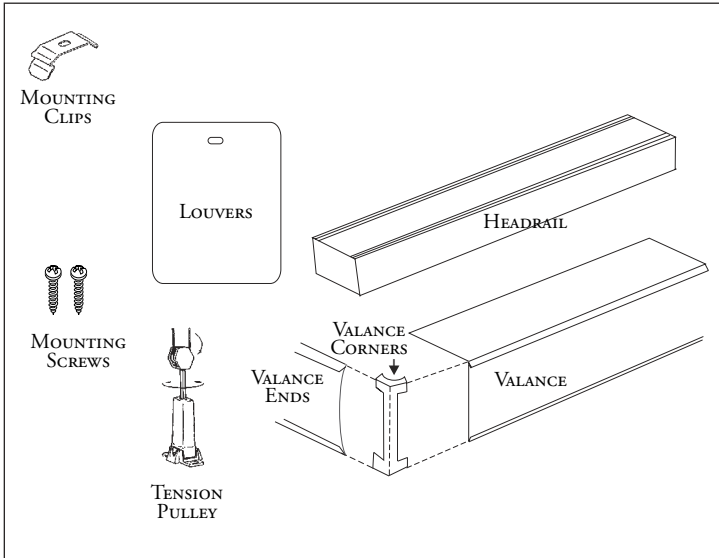

### HEADRAIL INSTALLATION WITHOUT A VALANCE

- 1 A) Measure 2 1/4" away from window pane. Mark with pencil (make sure your lines are at least 3" in from each end of the headrail). B) Align hole in mounting clip to mark made in last step. Mark the screw hole locations and space the remaining clips evenly. C) Drill at each mark. D) Mount clips with supplied screws.

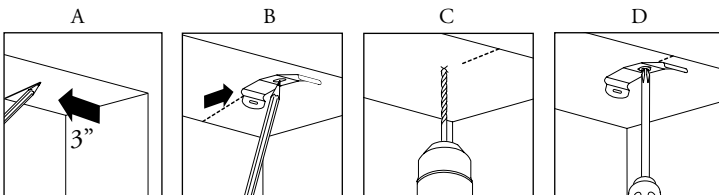

# 2

Snap headrail in place by inserting edge of headrail into front edge of mounting clip and rotating back until headrail snaps firmly into place.

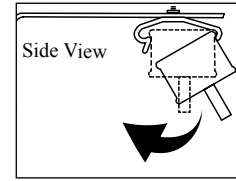

### HEADRAIL INSTALLATION WITH A VALANCE

# 1

For proper installation, a 3" depth is required on an inside mount valance. A minimum 2" clearance is required from the window or back wall and the back of the valance (2 1/4" is suggested). Locate the center of inside top of window reveal and make a small pencil mark at least 2" away from window glass. Drill at the mark.

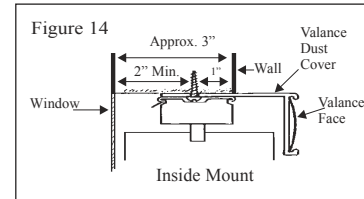

# 2

Turn the valance upside down and make a pencil mark in the center of the dust cover and 2 1/4" from the back of the valance face. Drill a hole at the mark and place the mounting screw into the hole in the dust cover.

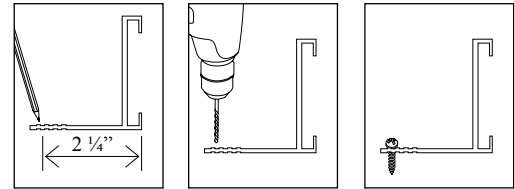

# 3

Align the two holes (steps 1 and 2) and secure the screw almost tight for now.

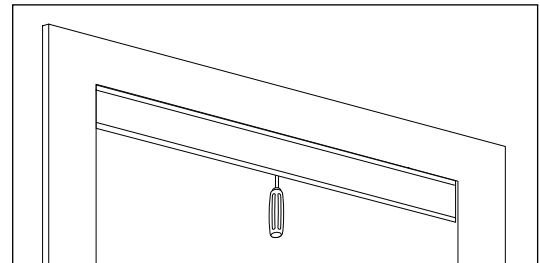

Note: the valance is designed so that the face will extend beyond the window opening on each side. The dust cover is cut out on each end to allow the valance to protrude into the window opening at the desired depth. If the two holes do not align because the valance face cannot be pushed inside the window, the first hole should be moved out to align with the hole in the valance dust cover.

**4** Rotate the valance as required so that the valance is square to the wall and tighten securely.

**5** Hold a mounting clip 3" away from each end of the valance and 2 1/4" away from the back face of the valance. Mark screw holes. Mount clips with supplied screws. Additional mounting clips should be equally spaced accordingly. This also secures the valance in place.

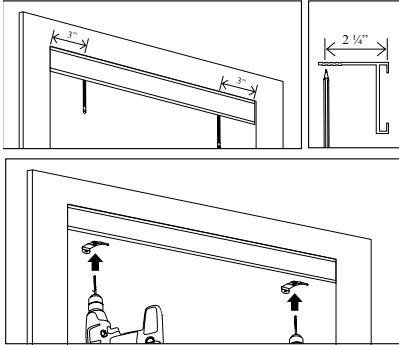

**6** Snap headrail in place by inserting edge of headrail into front edge of mounting clip and rotating back until the headrail snaps firmly in place.

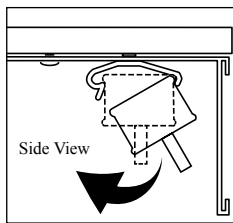

**7** Measure the distance from front face of valance to the wall. Mark valance return at the measured size. Cut return at mark with scissors. Insert valance return into corner joint. Attach the valance return and corner joint to the valance in the same fashion. Repeat for other side of valance.

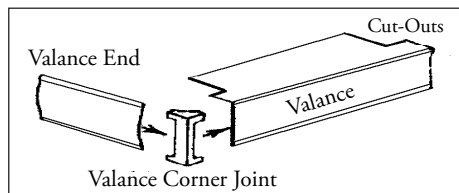

## LOUVER INSTALLATION

**1** Rotate louver stems so that vanes will be installed in the open position. See operating instructions if all clips are not facing the same direction.

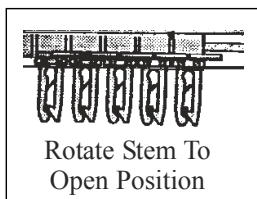

**2** Insert the slotted end of the louvers into the stem as far as it will go. Then gently pull down, ensuring that it catches on the hook inside the louver stem. Make sure all louvers are facing the same direction. Louvers can be removed by inserting a credit card or similar between the louver and stem leg that has the hook on it.

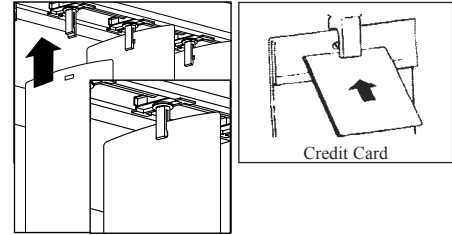

## CORD TENSION PULLEY INSTALLATION

**1** The cord tension pulley should be mounted slightly toward the back as to allow for free rotation of the vanes. A light amount of tension should be used - too much tension will interfere with smooth operation of blinds.

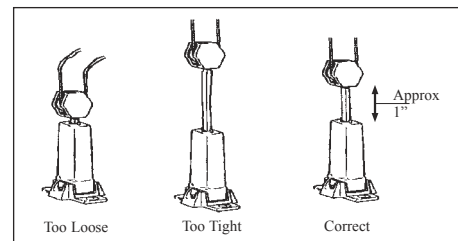

**2** Hold the pulley base in the desired location and mark the screw holes. Drill at marks, then mount the tension pulley with provided screws.

## OPERATING YOUR VERTICAL BLINDS

### To Open Louvers:

Pull cord to rotate the louvers to the desired position.

### To Open Blind:

Traverse the louvers across the headrail using the cord. Stacking of the louvers will vary depending on the draw (right, left or split) ordered.

### To Realign Louvers out of Sync

Pull cord until louvers are all closed. Continue pulling until you hear clicking sounds. Pull cord again rotating the vanes to close them in the other direction and pull once more until you hear clicking sounds.

## PROPER CARE OF VERTICAL BLINDS

Clean vinyl louvers with a soft damp cloth. Fabric louvers can be vacuumed with a soft attachment or spot cleaned with a mild detergent/damp cloth.